

## Oak Grove, Cricklewood, NW2

£299,995

1 1 1



**Please quote LR0444** - Beautifully presented one double bedroom second (top) floor apartment set within a popular modern development boasting well-maintained communal grounds, conveniently located close to Cricklewood station and local amenities. The property offers bright and spacious, well-proportioned accommodation with stylish interiors throughout, including a light and airy open plan reception/kitchen, and modern shower room. Further features include underfloor heating, double glazing, real oak flooring, ample inbuilt storage, communal bike store, and long lease.

## Key Features

- Well Presented One Double Bedroom Second Floor Flat
- Well Planned Accommodation with Modern Interiors
- Stylish Shower Room
- Communal Gardens with Bike Store
- Close to Cricklewood Station and Amenities
- Popular Modern Development
- Bright and Spacious Open Plan Reception/Kitchen
- Inbuilt Storage
- Long Lease
- Please quote LR0444

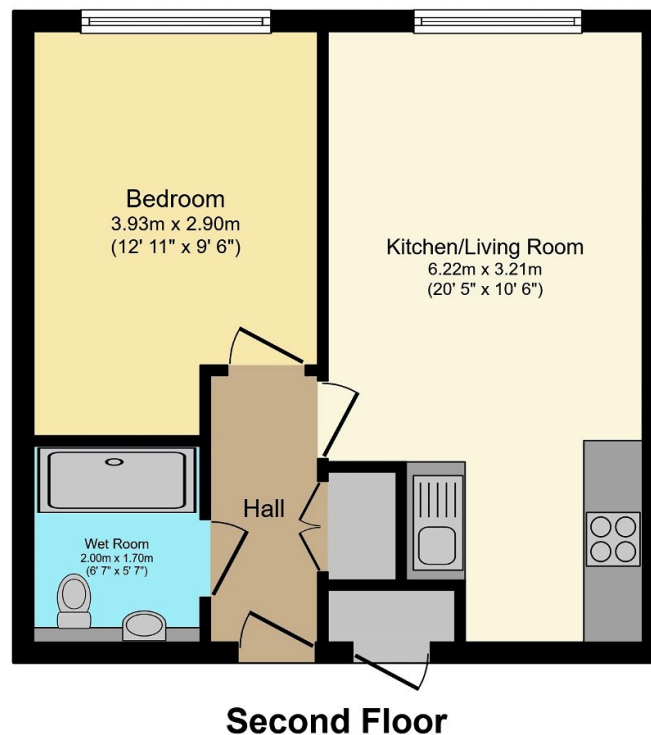

Total floor area 38.6 sq.m. (416 sq.ft.) approx

This plan is for illustration purposes only and may not be representative of the property. Plan not to scale. Powered by PropertyBox